

SAFETY FEATURES

1. A thermal overload protector is built in to the heater to prevent overheating.
2. If an overheat temperature is reached, the heater will automatically shut off. It can only resume operation when the user resets the unit.

To reset the heater:

1. Turn Control to OFF.
2. Unplug the unit and wait 30 minutes.
3. Plug in and operate normally.

SPECIFICATIONS

Working Voltage: 120V AC/60Hz

Amps: 12.5

Wattage: 1500W (+5%-10%)

SERVICE & SUPPORT

In the event service of the device is required or if you have any questions, please contact us at:

service@PackTite.com

Patent Pending

EPA Est. No. 85055

PackTite 2™ is assembled in the United States from components made in China, Taiwan and the U.S.A.

PT2 V1 03152014

PackTite 2™

ASSEMBLY AND OPERATING INSTRUCTIONS

Patent pending heating system safely eliminates all stages of bed bugs.



Read these instructions carefully before using this device.

For demonstrations on assembly and use, go to the PackTite page on Facebook (www.facebook.com/packtite)

IMPORTANT OPERATI



When using electrical appliances, basic precautions should always be followed to reduce the risk of fire, electrical shock and injury to persons, including the following:

1. Read all instructions before using this device.
2. Use the heater unit only as described in this manual.
3. Do not use extension cords with the heater.
4. ALWAYS plug heaters directly into a wall outlet/receptacle.
5. DO NOT plug heater into any other cord-connected device, such as a power strip, surge protector, multiple outlet adapter, cord reel or outlet-type air freshener. The use of such devices may create a fire hazard.
6. Plug unit directly into a 120V wall outlet only.
7. Be sure that the plug fits snugly in the outlet before each use. A loose plug can overheat. Faulty wall outlet connections may cause the wall outlet to overheat. Check to make certain the heater plug is not overheating. If necessary, have a qualified electrician check and/or replace the wall outlet.
8. DO NOT use this heater with any solid state speed control devices.
9. DO NOT OVERLOAD CIRCUITS.
10. Make certain the power source conforms to the electrical requirements of the heater.
11. Only connect heater to a properly grounded outlet.
12. Keep combustible materials out of contact with the heating unit and heating elements.
13. Clean the PackTite 2™ unit after every use. DO NOT allow dust, hair, insects or other debris to build up in the unit.
14. DO NOT operate this device around children, animals or invalids.
15. DO NOT use this device where oxygen tanks are used or stored.
16. Always unplug the device when not in use.
17. DO NOT operate this device with a damaged cord or plug or after the device has malfunctioned, has been dropped or damaged in any manner.
18. DO NOT use this device outdoors.
19. The heater and heater housing are HOT when in use. To avoid burns, DO NOT let bare skin touch the hot surfaces. Always use the heater handle and the enclosure handles when moving the unit.
20. DO NOT operate in bathrooms, laundry areas and similar indoor locations where it may come into contact with water. Never locate the device where it may fall into a bathtub or other water container.
21. DO NOT run cord under carpeting or cover cord with throw rugs, runners or similar coverings. Arrange cord and device away from traffic areas and where it will not be tripped over.
22. Before unplugging the device, turn the heater setting knobs to OFF.

IMPORTANT

Never leave the unit unattended while it is operating.

THE FOLLOWING ITEMS SHOULD NOT BE TREATED IN THE PackTite 2™: medications, liquid, food, aerosol cans, flammable materials.

PackTite 2™ is not recommended for treating electronic devices, including cameras, laptop or other computers, phones, ipods, MP3 players, etc.

Always operate the PackTite 2™ unit in ambient temperature conditions of at least 70° F. Colder ambient temperatures may prevent the device and the contents from reaching temperatures needed to kill bedbugs. Take care not to overfill the PackTite 2™ unit.

The black heater housing may become hot while the unit is operating. To avoid burns, do not touch the housing or the heater until the unit is OFF and completely cooled down.

CLEANING & MAINTENANCE

1. Always unplug the PackTite 2 before cleaning.
2. Remove the heater from the heater housing.
3. Lightly run a vacuum cleaner nozzle (with brush attachment) over the shelf and on the interior surfaces of the enclosure.
4. Carefully wipe the enclosure interior with a soft, damp cloth and then again with a dry cloth.
5. Leave the flap open and allow the enclosure to dry completely before using.
6. Store the PackTite 2 in the original carton in a cool, dry location.

Heater Cleaning/Maintenance

WARNING: To reduce the risk of electrical shock and fire please observe the following instructions.

Cleaning the heater regularly will help to maintain its efficiency.

1. Always unplug the heater before cleaning.
2. Clean the unit with a soft cloth moistened with a mild soap and water solution.
3. NEVER use abrasive or flammable solvents to clean the unit.
4. After cleaning, be sure to completely dry the unit with a cloth or towel.
5. Store heater in a cool, dry location.

- c. Make sure the heater is sitting upright on the base of the heater housing and is positioned behind the front bracket.
- d. Move the heater backwards approximately 1 inch (keeping it inside the housing) and restart.

DO NOT ATTEMPT TO OPEN OR REPAIR THE HEATER YOURSELF. DOING SO COULD CAUSE DAMAGE OR PERSONAL INJURY OR DEATH.

If the problem cannot be resolved by the steps listed above, contact technical assistance at service@packtite.com.

TEMPERATURE MONITORING

Studies show that it is necessary to reach and hold a specific temperature in order to kill all life stages of bed bugs (egg, larvae and adult). To insure elimination of all bedbugs, MONITOR the temperature of items being treated to insure they reach (and hold) this lethal temperature.

Luggage

Place the temperature probe inside the pocket of a piece of clothing inside the luggage or attach the probe to the item using a clip or clothespin. Alternatively, place the temperature probe inside a pouch or compartment of the luggage.

Personal Items

Heating of personal items in the PackTite 2™ will vary, depending upon number and types of items being treated. For clothing, place the temperature probe inside the pocket of a piece of clothing or attach the probe to the item using a clip or clothespin. For other items, place the probe in the center of the item being treated (purse, shoe, backpack, etc.).

Recommended Temperature Cycles

- 118 degrees (F) - hold for 1.5 hours
- 120 degrees (F) - hold for 1 hour
- 125 degrees (F) - hold for 1/2 hour

If the internal temperature of the item does not reach the required lethal temperature within a reasonable time, the PackTite 2™ unit may be overloaded. Remove some items and restart the unit.

Do not treat items that are enclosed in paper wrapping, Styrofoam, cardboard or plastic tubs. These materials act as heat insulators and will prevent items from reaching critical the temperature. Remove items from such packaging and treat packaging separately.

NOTE: For tips and demonstrations on treating specific items, visit the PackTite page on facebook: (facebook.com/packtite).

- 23. DO NOT cover or obscure the top vent of the enclosure.
- 24. DO NOT insert or allow foreign objects to enter any ventilation or exhaust openings in the heater as this may cause an electric shock or fire, or damage the heating unit.
- 25. DO NOT leave the unit unattended while in operation.
- 26. DO NOT overfill the device.
- 27. DO NOT put damp or wet items in the device. Do not use the device as a dryer.
- 28. DO NOT use this device in areas where gasoline, paint or other flammable materials are used or stored.
- 29. DO NOT plug the heater into the same circuit as other appliances.
- 30. It is normal for the plug to feel warm to the touch; however, a loose fit between the AC outlet (wall receptacle) and the plug may cause overheating and distortion of the plug. Contact a qualified electrician to replace loose or worn outlets.
- 31. Use of this device is not recommended for persons with reduced sensitivity to heat or an inability to react to avoid burns.
- 32. This device includes an Overheat Protection System that shuts the heating unit off if it overheats due to abnormal conditions. If this occurs, turn the heater off, and unplug it. Allow the device to cool for a few minutes, plug it back in, and resume normal operation.
- 33. DO NOT place infants or animals in the enclosure or allow them to get inside the enclosure.
- 34. This device is intended for use by persons 18 years and older.
- 35. Never pull this device by the electrical cord.
- 36. DO NOT bend or pinch the cord and do not use if the cord is damaged.
- 37. DO NOT attempt to open or repair this device yourself.
- 38. NEVER allow pets or children near an electric heater. Accidental contact could result in serious shock or burns.
- 39. This appliance has a polarized plug (one blade wider than the other). To reduce the risk of electrical shock, the plug is intended to fit in a polarized outlet only one way. If the plug does not fit fully in the outlet, reverse the plug. If it still does not fit, contact a qualified electrician. Do

NOTE: ONLY operate the PackTite 2™ with the heater that came with the product. Other types of units may cause the unit to malfunction or overheat, resulting in fire or injury or may cause damage to the unit. The heater housing on the PackTite 2™ is specifically designed for use with the heater provided.

NOTE: If the heater stops and starts intermittently or shuts down altogether:

- a. Make sure the top vent on the bag enclosure is not blocked in any way.
- b. Turn the heater controls to OFF and unplug the heater. Allow the unit to cool completely, then plug in and restart the unit.

IMPORTANT OPERATING INSTRUCTIONS

not attempt to defeat this safety feature.

40. DO NOT block air intakes or exhaust in any manner. Do not place on soft surfaces, like a bed, where openings may become blocked.
41. DO NOT depend on the on/off switch as the sole means of disconnecting power when servicing or moving the heater.
42. Make sure room is equipped with a working smoke detector.
43. This heater is not suitable for use in hazardous locations. Please refer to

National Electric Cod (NEC) Article 500 or applicable state or local codes or standards relating to electrical requirements for Hazardous locations.

44. This heater does NOT meet the requirements of NEC article 500 (2008).
45. DO NOT insert or allow foreign objects to enter any ventilation or exhaust opening as this may cause an electric shock or fire, or damage the heater.
46. SAVE THESE INSTRUCTIONS.

ASSEMBLY INSTRUCTIONS

Set up Bag Enclosure

1. Remove PackTite enclosure (and shelf), heater and heater box from the box and remove all packaging materials (plastic cover, bubble wrap, etc.).
2. Unfold the bag so that the vent is on top and the heater bracket is facing to the right.
3. Place the unit on a firm, level surface and at least 3 feet away from walls, furniture, curtains, plants or combustible materials.
4. Unzip the top flap and shift or adjust the shelf so that the bottom of each leg sits firmly in the bottom corner of the enclosure.
5. Pull up the support bar on each side of the shelf to an upright position until the

metal guides on either side lock into place just on top of the shelf.

6. Position the unit so that the “PackTite” logo is facing to the front.

Attach Heater

1. Attach the heater housing to the opening window frame for the heater by hooking the bottom metal clip underneath the window frame and hooking the two side clips around each side of the window frame.

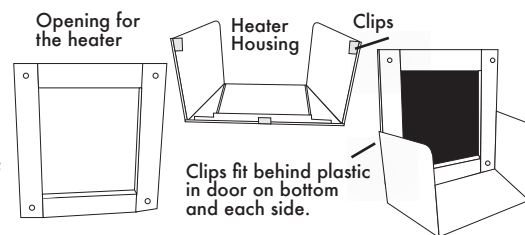

ASSEMBLY INSTRUCTIONS

2. Insert heater into the heater housing from the top.
3. The heater should sit level inside the housing with the front touching the placement bracket
4. The front of the heater should face towards the enclosure and the cord should be extended from the back of the heater out of the heater housing.
5. Plug the heater cord directly into the wall outlet.

personal items (purses, backpacks, etc.) open or unzip any interior or exterior compartments.

4. This unit comes with a thermometer/timer device. Place the thermometer probe inside any item to be monitored (pocket, shoe, suitcase, etc.). Zip the top flap closed with the thermometer cord extending out the upper corner of the flap. Be careful to not zip the flap too tightly. This will damage the thermometer cord and reduce the life of the device.
5. Set both controls on the heater to the highest settings (heat and air flow).

Load and Operate

1. Place items to be treated on the shelf and distribute evenly.
2. Take care not to overfill the unit. For proper operation, items should not extend beyond the orange strips on either side of the shelf or above the height of the support bar. DO NOT BLOCK THE VENT.
3. When treating luggage, open luggage top and unzip any pouches or exterior compartments to allow heat to circulate through the interior. When treating

Shut Down Procedure

1. When finished with a treatment cycle, leave the airflow setting on HIGH and turn the heat setting to FAN. Unzip the top flap and run in this manner for at least 10 minutes.
2. Turn the heater controls to OFF, unplug the heater, unzip the top flap and remove contents.

TROUBLE SHOOTING TIPS

If the heater shuts off unexpectedly or fails to operate, the above-mentioned safety feature may have been activated to prevent overheating.

If the heater runs for several minutes and shuts off repeatedly, the heater is overheated.

1. Be sure the power cord is plugged into a working electrical outlet.
2. Make sure the circuit breaker or fuse is working properly.

- a. Make sure the back of the unit (heater end) is at least 3 feet from any object.
- b. Make sure the contents being treated are not blocking air from exiting the vent in the top of the enclosure